

Antenna-Railway-Indoor-4W

Bahntaugliche Innen-Antenne mit 4x4 MIMO WLAN + EN50155 + 3m Kabel

Vertikal- und kreuzpolarisierte Dual-Band-Antenne zur Signalverbesserung in WLAN-Netzwerken.

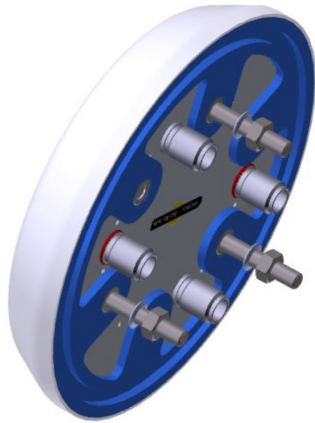

Hauptmerkmale

WiFi / WLAN	MIMO 2.4 / 5 GHz
Railway	EN50155, EN45545
Coach	ECE R118

Spezifikation

WiFi / WLAN	Standards	4 x Dual-band WLAN 2.4/5 GHz Frequency (MHz) 2400 - 2500, 5180 - 5835
	Specification	Gain 7,5 dBi (WLAN 2.4) / 8,3 dBi (WLAN 5) (connector a and c) 8,2 dBi (WLAN 2.4) / 8,5 dBi (WLAN 5) (connector b and d) VSWR ≤ 1,8 typ. Impedance 50 Ohm Radiation omnidirectional
	Connectors	4x N female Type N Gender Female
Mechanical	Dimensions	Diameter 200 mm Height 40 mm
	Weight	1000 g
	Mounting	Rooftop with screws
	Color	black
Environment	Operating Temperature	-40°C bis +80°C
	Ingress Protection Level	IP42
Certifications	Compliance Standards	EN 50155, EN 45545-2, ECE R118 IEC 61373, 2014/30/EU; 2006/28/EC; 2002/95/EC
	Domain	Railway
Extension Cables	WLAN	4 x Ant-Cable-Railway-01-Nm-TNCm-3 / 3 m / N male / TNC male
Other	Order Code	Antenna-Railway-Indoor-4W